



72 Marlborough Road, Gloucester, GL4 6GD

Offers Over £270,000

Charming semi-detached home offers a delightful blend of comfort and style. The property boasts a spacious bay fronted living room, complete with a feature fireplace that creates a warm and inviting atmosphere. Adjacent to this, a separate dining room flows effortlessly into a bright double-glazed conservatory, perfect for enjoying the garden views throughout the year.

The extended galley-style kitchen is a highlight of the home, flooded with natural light, making it an ideal space for culinary enthusiasts. This well-designed area provides ample storage and workspace, ensuring that meal preparation is both enjoyable and efficient.

The property features two double bedrooms equipped with built-in wardrobe providing plenty of storage space along with an additional generous third single bedroom. These bedrooms are serviced by a modern bathroom, which adds a touch of contemporary elegance to the home.

Set on a large plot, the property enjoys an open aspect to the rear, offering a sense of privacy and tranquility. Additionally, the ample driveway parking ensures convenience for residents and guests alike.

- Bay-fronted semi detached home
 - Large open aspect garden
 - Three bedrooms
 - Three reception rooms
 - Ample driveway parking
 - South facing garden

Approx Gross Internal Area
82 sq m / 884 sq ft

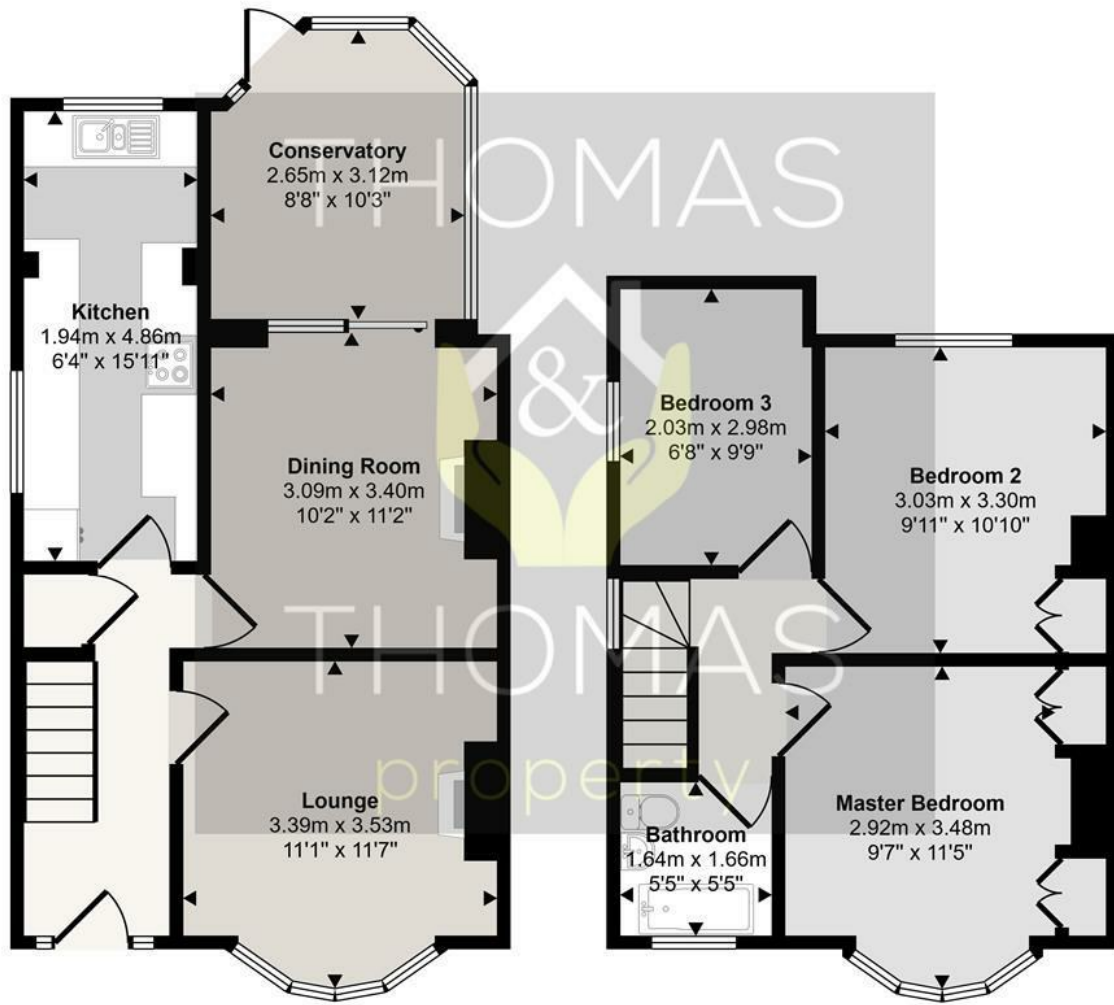

Ground Floor
Approx 47 sq m / 505 sq ft

First Floor
Approx 35 sq m / 379 sq ft

This floorplan is only for illustrative purposes and is not to scale. Measurements of rooms, doors, windows, and any items are approximate and no responsibility is taken for any error, omission or mis-statement. Icons of items such as bathroom suites are representations only and may not look like the real items. Made with Made Snappy 360.

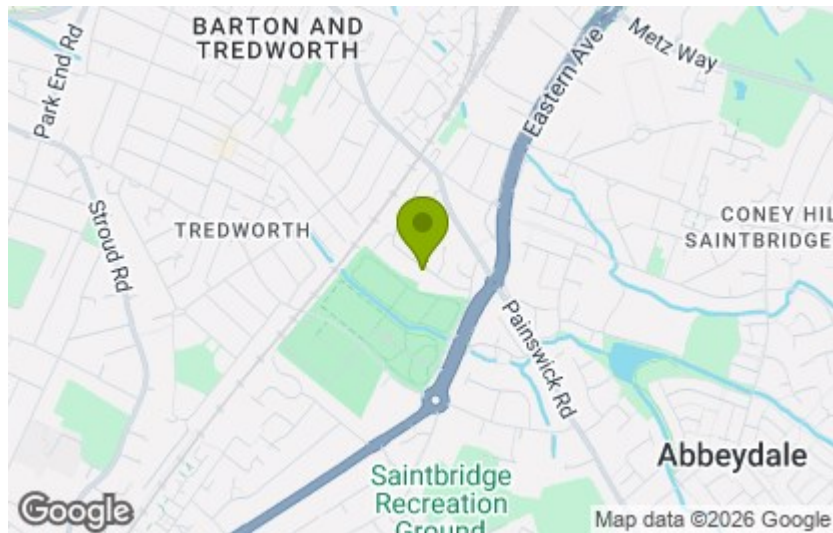

| Energy Efficiency Rating | |
|---|-------------------------|
| Current | Potential |
| | 83 |
| | 63 |
| <small>Very energy efficient - lower running costs</small> (92 plus) A (81-91) B (69-80) C (55-68) D (39-54) E (21-38) F (1-20) G <small>Not energy efficient - higher running costs</small> | |
| England & Wales | EU Directive 2002/91/EC |

| Environmental Impact (CO ₂) Rating | |
|---|-------------------------|
| Current | Potential |
| | |
| | |
| <small>Very environmentally friendly - lower CO₂ emissions</small> (92 plus) A (81-91) B (69-80) C (55-68) D (39-54) E (21-38) F (1-20) G <small>Not environmentally friendly - higher CO₂ emissions</small> | |
| England & Wales | EU Directive 2002/91/EC |

These particulars, whilst believed to be accurate are set out as a general outline only for guidance and do not constitute any part of an offer or contract. Intending purchasers should not rely on them as statements of representation of fact, but must satisfy themselves by inspection or otherwise as to their accuracy. No person in this firm's employment has the authority to make or give any representation or warranty in respect of the property.