



67 Mayfield Drive, Gloucester, GL3 3DT

Asking Price £300,000

Welcome to this stunning three-bedroom semi-detached property, perfectly presented throughout and ideally situated in a highly sought-after location. Offering a wonderful combination of modern comforts and practical living spaces, this home is ready for you to move straight in.

The ground floor features a bright and spacious living area, a stylish downstairs bathroom, and a well-appointed kitchen that flows seamlessly into a useful utility room—perfect for everyday convenience. Upstairs, you'll find three well-proportioned bedrooms, offering plenty of space for families, guests, or a home office.

Outside, the property boasts a generous, well-maintained garden, ideal for relaxing, entertaining, or enjoying outdoor activities. To the front, a garage and private driveway provide ample parking.

This home is perfect for families, first-time buyers, or anyone looking for a beautifully maintained property in a great area. Early viewing is highly recommended!

- Three bedrooms
- Garage and driveway parking
- Immaculate condition
 - Great location
 - Good size garden
- Downstairs bathroom

Approx Gross Internal Area
80 sq m / 861 sq ft

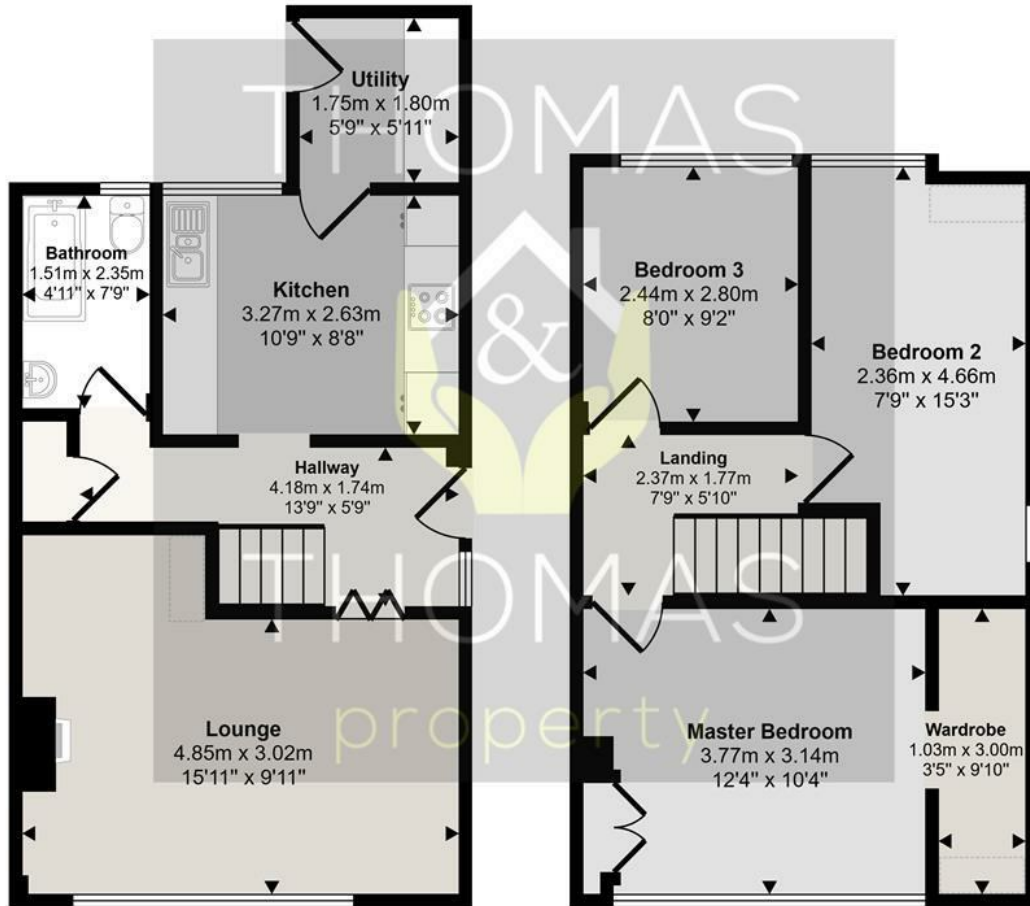

Ground Floor
Approx 41 sq m / 442 sq ft

First Floor
Approx 39 sq m / 419 sq ft

Denotes head height below 1.5m

This floorplan is only for illustrative purposes and is not to scale. Measurements of rooms, doors, windows, and any items are approximate and no responsibility is taken for any error, omission or mis-statement. Icons of items such as bathroom suites are representations only and may not look like the real items. Made with Made Snappy 360.

Energy Efficiency Rating	
Current	Potential
Very energy efficient - lower running costs	
(92 plus) A	
(81-91) B	
(69-80) C	
(55-68) D	
(39-54) E	
(21-38) F	
(1-20) G	
Not energy efficient - higher running costs	
68	76
England & Wales	
EU Directive 2002/91/EC	

Environmental Impact (CO ₂) Rating	
Current	Potential
Very environmentally friendly - lower CO ₂ emissions	
(92 plus) A	
(81-91) B	
(69-80) C	
(55-68) D	
(39-54) E	
(21-38) F	
(1-20) G	
Not environmentally friendly - higher CO ₂ emissions	
England & Wales	
EU Directive 2002/91/EC	

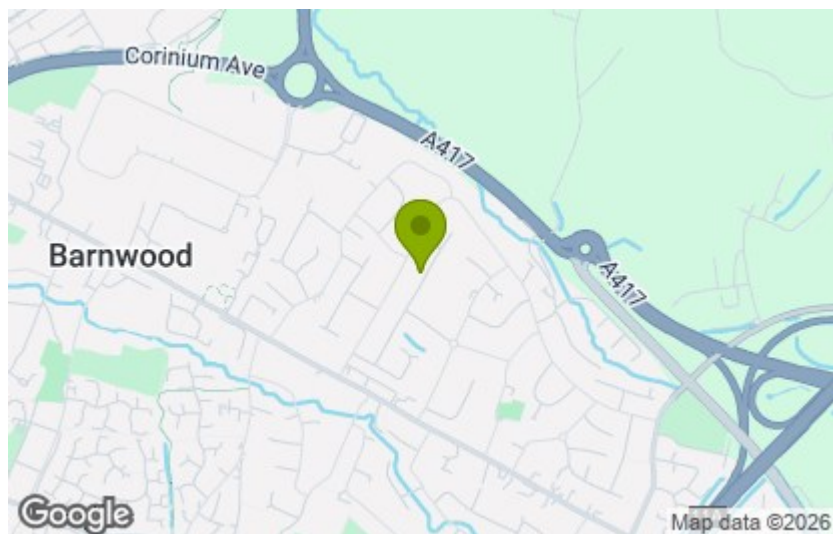

These particulars, whilst believed to be accurate are set out as a general outline only for guidance and do not constitute any part of an offer or contract. Intending purchasers should not rely on them as statements of representation of fact, but must satisfy themselves by inspection or otherwise as to their accuracy. No person in this firm's employment has the authority to make or give any representation or warranty in respect of the property.