



## 58 Freemans Road, Gloucester, GL4 0XJ

£1,700 Per Month

A spacious family home which is located within a small development of Tuffley

Internally the accommodation comprises, an entrance hall, two separate reception rooms, one being a lounge and the other is currently used as a study/second lounge.

Across the rear aspect, almost spanning the full width of this property is an open plan kitchen/breakfast room where there is room for an additional dining table or sofa. The ground floor is completed with a separate utility space and a downstairs wc.

Upstairs there are four bedrooms where the master benefits from en-suite shower facilities and a family bathroom.

Externally to the side aspect is a single garage with driveway parking for two vehicles, gated side access which then leads through to its enclosed rear garden.

A full virtual tour can be found online, so please enquire for further information and to arrange your viewing.

- Four Bedroom Detached
  - Garage
  - Kitchen/Diner
- Two Reception Rooms
- Gas Central Heating
- Available End July

Approx Gross Internal Area  
112 sq m / 1209 sq ft

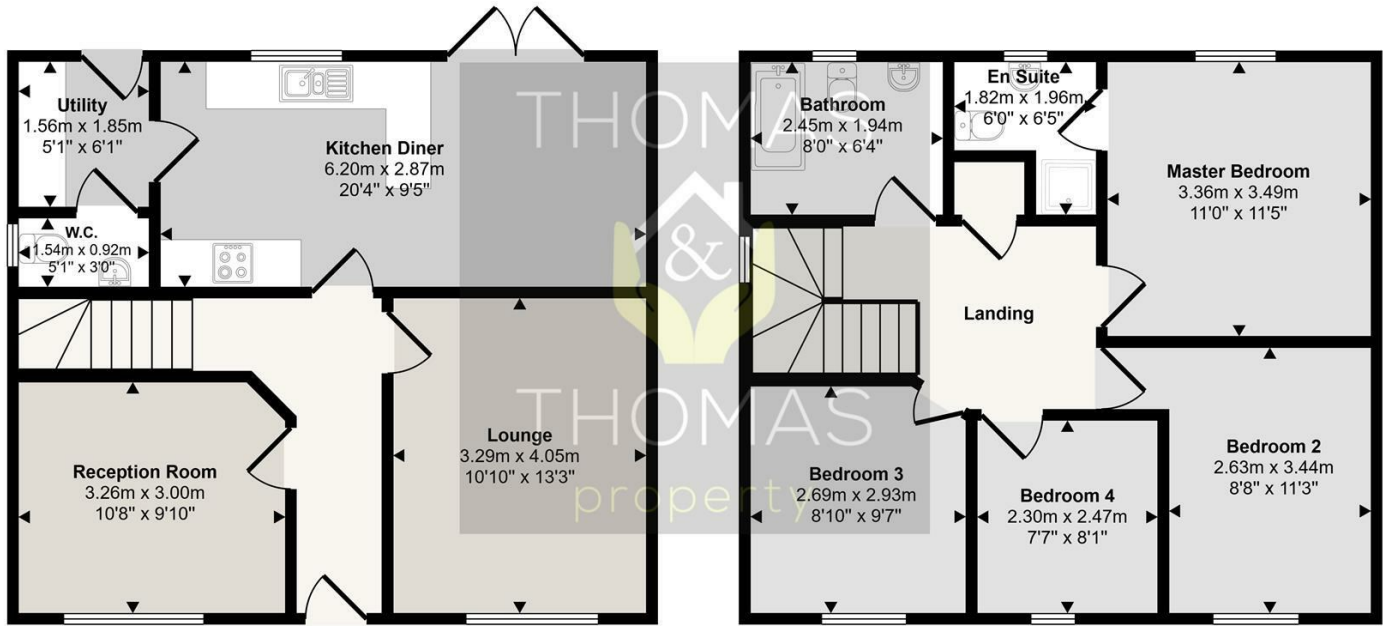

This floorplan is only for illustrative purposes and is not to scale. Measurements of rooms, doors, windows, and any items are approximate and no responsibility is taken for any error, omission or mis-statement. Icons of items such as bathroom suites are representations only and may not look like the real items. Made with Made Snappy 360.

Energy Efficiency Rating		
	Current	Potential
Very energy efficient - lower running costs		
(92 plus) <b>A</b>		
(81-91) <b>B</b>		
(69-80) <b>C</b>		
(55-68) <b>D</b>		
(39-54) <b>E</b>		
(21-38) <b>F</b>		
(1-20) <b>G</b>		
Not energy efficient - higher running costs		
England & Wales	EU Directive 2002/91/EC	

Environmental Impact (CO <sub>2</sub> ) Rating		
	Current	Potential
Very environmentally friendly - lower CO <sub>2</sub> emissions		
(92 plus) <b>A</b>		
(81-91) <b>B</b>		
(69-80) <b>C</b>		
(55-68) <b>D</b>		
(39-54) <b>E</b>		
(21-38) <b>F</b>		
(1-20) <b>G</b>		
Not environmentally friendly - higher CO <sub>2</sub> emissions		
England & Wales	EU Directive 2002/91/EC	



These particulars, whilst believed to be accurate are set out as a general outline only for guidance and do not constitute any part of an offer or contract. Intending purchasers should not rely on them as statements of representation of fact, but must satisfy themselves by inspection or otherwise as to their accuracy. No person in this firms employment has the authority to make or give any representation or warranty in respect of the property.