



## 7 Katherine Close, Gloucester, GL3 1PB

Offers Over £300,000

We are pleased to be offering this well presented three bedroom semi detached property in Churchdown.

Briefly comprising of, entrance hallway leading to spacious lounge with doors to dining room and kitchen which includes integrated fridge freezer and washing machine. Upstairs the master bedroom benefits from fitted wardrobe space, a second double bedroom and small single. A modern bathroom in excellent condition with shower over bath.

The property also benefits from overlooking a green space to the front, a very well maintained enclosed rear garden with side access to the parking.

- Great Location
- Three Bedrooms
- Parking For 2/3 Cars
- Overlooking Greenery
- Well Presented
- Private Enclosed Garden



Approx Gross Internal Area  
68 sq m / 734 sq ft

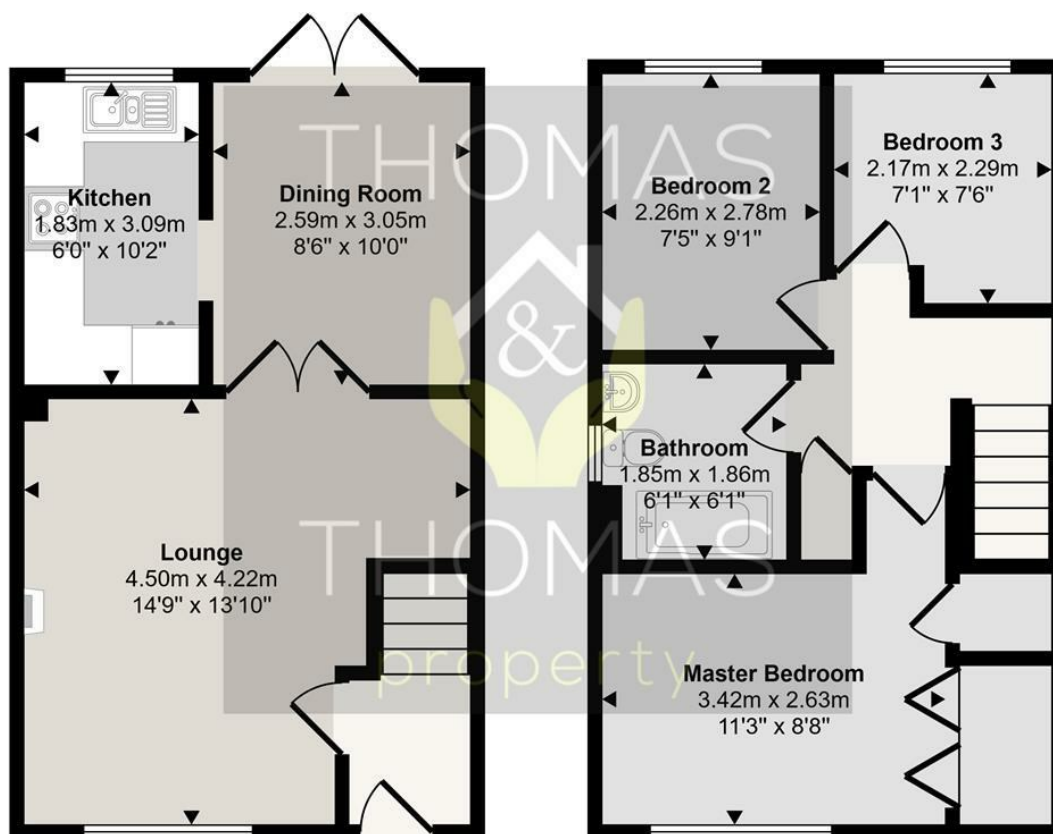

This floorplan is only for illustrative purposes and is not to scale. Measurements of rooms, doors, windows, and any items are approximate and no responsibility is taken for any error, omission or mis-statement. Icons of items such as bathroom suites are representations only and may not look like the real items. Made with Made Snappy 360.

Energy Efficiency Rating		
	Current	Potential
Very energy efficient - lower running costs		
(92 plus) <b>A</b>		
(81-91) <b>B</b>		
(69-80) <b>C</b>		
(55-68) <b>D</b>		
(39-54) <b>E</b>		
(21-38) <b>F</b>		
(1-20) <b>G</b>		
Not energy efficient - higher running costs		
England & Wales	EU Directive 2002/91/EC	

Environmental Impact (CO <sub>2</sub> ) Rating		
	Current	Potential
Very environmentally friendly - lower CO <sub>2</sub> emissions		
(92 plus) <b>A</b>		
(81-91) <b>B</b>		
(69-80) <b>C</b>		
(55-68) <b>D</b>		
(39-54) <b>E</b>		
(21-38) <b>F</b>		
(1-20) <b>G</b>		
Not environmentally friendly - higher CO <sub>2</sub> emissions		
England & Wales	EU Directive 2002/91/EC	

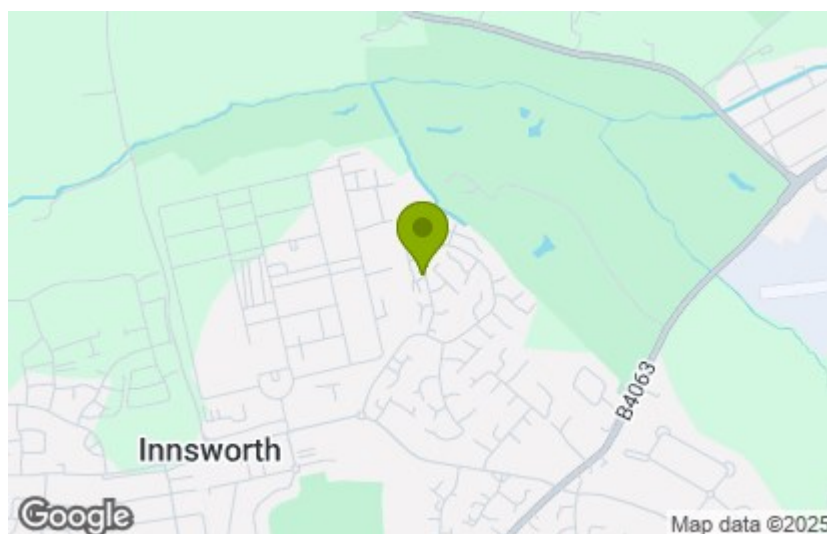

These particulars, whilst believed to be accurate are set out as a general outline only for guidance and do not constitute any part of an offer or contract. Intending purchasers should not rely on them as statements of representation of fact, but must satisfy themselves by inspection or otherwise as to their accuracy. No person in this firm's employment has the authority to make or give any representation or warranty in respect of the property.