



22 Morpeth Street, Gloucester, GL1 4TN

Asking Price £245,000

 4
  2
  2
  D

A spacious three bedroom semi detached property offering versatile living accommodation which benefit from two bathrooms and two separate reception rooms. Whilst the property lends itself to a family home, it also lends itself to ideal investment opportunity as a house of multiple occupation. The ground floor the property consists of an entrance hall, two reception rooms, a modern fitted kitchen and bathroom. Upstairs there are three bedrooms and a further shower room. Additional benefits include double glazing, gas central heating and no onward chain

- Three Bedrooms
- Semi Detached
- Two Bathrooms
- Modern Kitchen
- No Onward Chain
- Two Reception Rooms

Viewing

Please contact our Thomas & Thomas property Ltd Office on 01452 348208 if you wish to arrange a viewing appointment for this property or require further information.

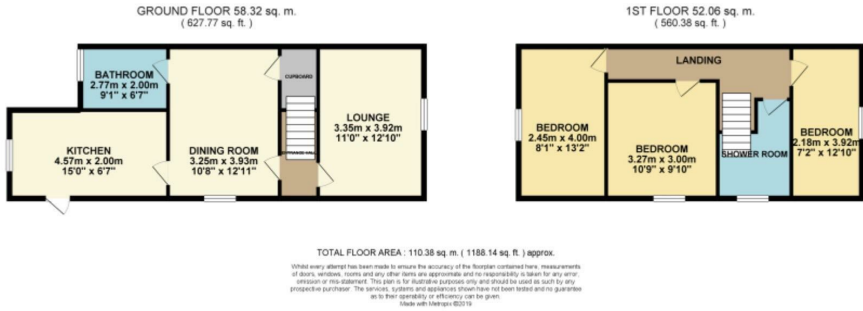

Energy Efficiency Rating			Environmental Impact (CO ₂) Rating		
	Current	Potential		Current	Potential
Very energy efficient - lower running costs			Very environmentally friendly - lower CO ₂ emissions		
(92 plus) A			(92 plus) A		
(81-91) B			(81-91) B		
(69-80) C			(69-80) C		
(55-68) D			(55-68) D		
(38-54) E			(38-54) E		
(21-38) F			(21-38) F		
(1-20) G			(1-20) G		
Not energy efficient - higher running costs			Not environmentally friendly - higher CO ₂ emissions		
England & Wales	EU Directive 2002/91/EC		England & Wales	EU Directive 2002/91/EC	



These particulars, whilst believed to be accurate are set out as a general outline only for guidance and do not constitute any part of an offer or contract. Intending purchasers should not rely on them as statements of representation of fact, but must satisfy themselves by inspection or otherwise as to their accuracy. No person in this firms employment has the authority to make or give any representation or warranty in respect of the property.