



**28 Brockeridge Close, Gloucester, GL2 4FY**

**£925 Per Calendar Month**

Located at the end of a cul-de-sac in Quedgeley is this well presented two bedroom property. The property comprises, an entrance hall, lounge, two bedrooms and a bathroom. Additionally the property benefits from UPVC double glazing, gas central heating and two allocated parking spaces.  
Available June 2024!

- Two Bedrooms
- Kitchen & Bathroom
- Gas Central Heating
- Two Allocated Parking Spaces
- Enclosed Rear Garden
- Available June

GROUND FLOOR 25.59 sq. m.  
( 275.42 sq. ft. )

1ST FLOOR 25.58 sq. m.  
( 275.37 sq. ft. )

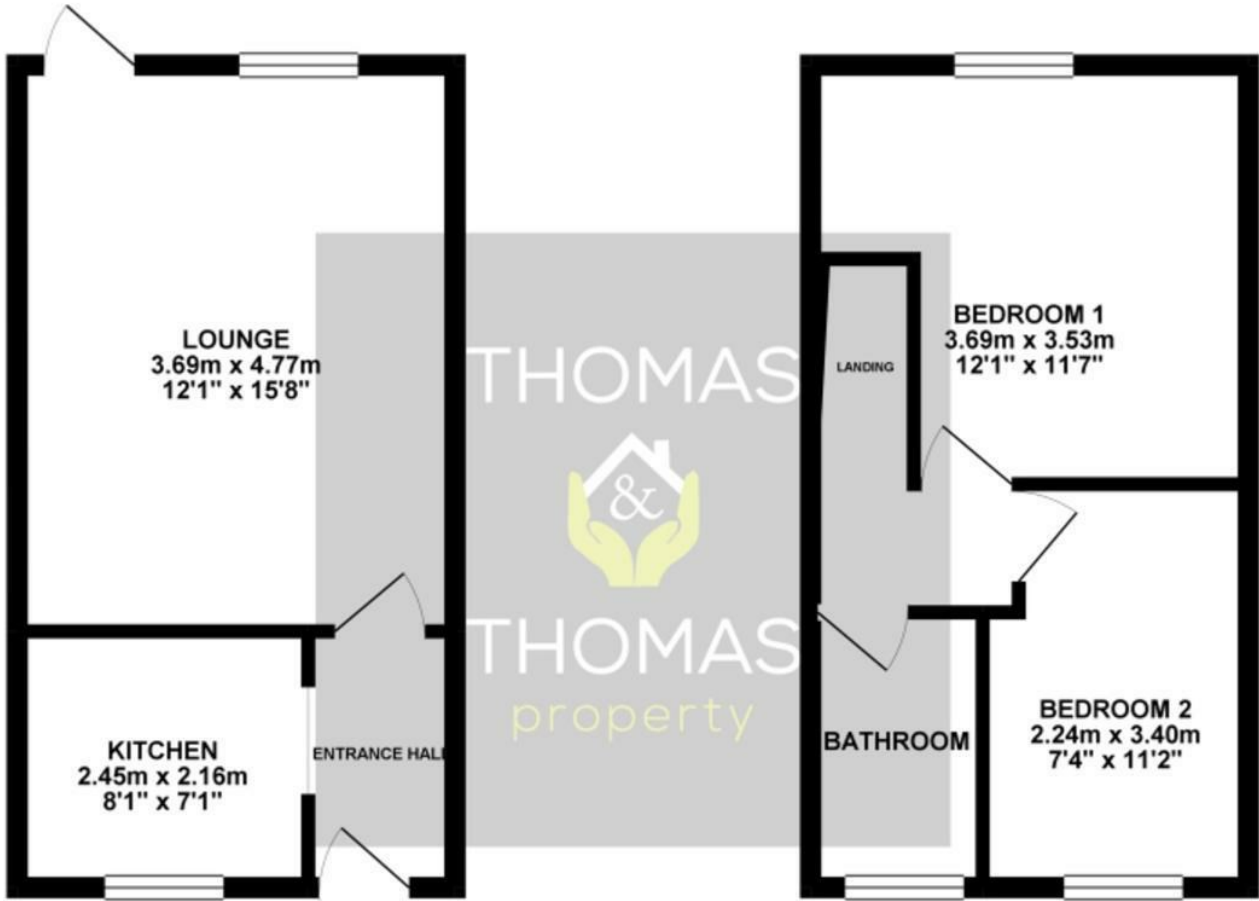

TOTAL FLOOR AREA : 51.17 sq. m. ( 550.79 sq. ft. ) approx.

Whilst every attempt has been made to ensure the accuracy of the floorplan contained here, measurements of doors, windows, rooms and any other items are approximate and no responsibility is taken for any error, omission or mis-statement. This plan is for illustrative purposes only and should be used as such by any prospective purchaser. The services, systems and appliances shown have not been tested and no guarantee as to their operability or efficiency can be given.  
Made with Metropix ©2020

Energy Efficiency Rating	
Current	Potential
69	92
<small>Very energy efficient - lower running costs</small> (92 plus) <b>A</b> (81-91) <b>B</b> (69-80) <b>C</b> (55-68) <b>D</b> (39-54) <b>E</b> (21-38) <b>F</b> (1-20) <b>G</b> <small>Not energy efficient - higher running costs</small>	
England & Wales EU Directive 2002/91/EC	

Environmental Impact (CO <sub>2</sub> ) Rating	
Current	Potential
71	95
<small>Very environmentally friendly - lower CO<sub>2</sub> emissions</small> (92 plus) <b>A</b> (81-91) <b>B</b> (69-80) <b>C</b> (55-68) <b>D</b> (39-54) <b>E</b> (21-38) <b>F</b> (1-20) <b>G</b> <small>Not environmentally friendly - higher CO<sub>2</sub> emissions</small>	
England & Wales EU Directive 2002/91/EC	

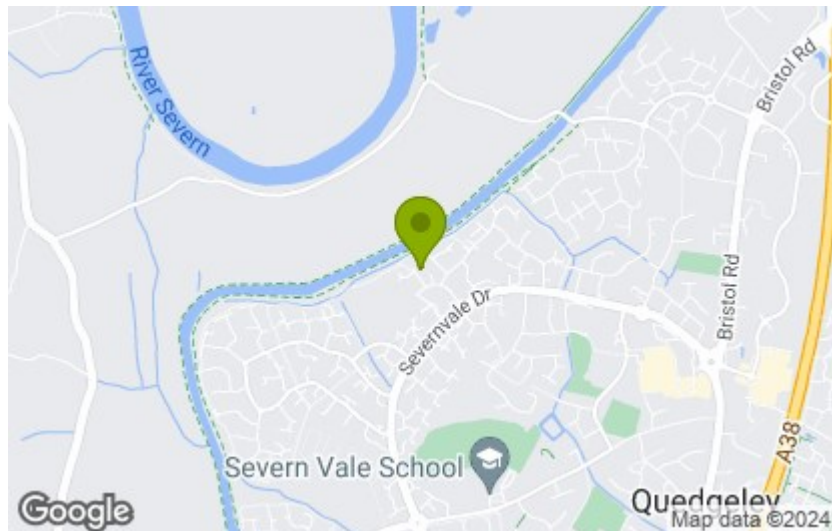

These particulars, whilst believed to be accurate are set out as a general outline only for guidance and do not constitute any part of an offer or contract. Intending purchasers should not rely on them as statements of representation of fact, but must satisfy themselves by inspection or otherwise as to their accuracy. No person in this firm's employment has the authority to make or give any representation or warranty in respect of the property.